

p/n 230-17422

ASSEMBLY INSTRUCTIONS

NOTE: Numbers in parenthesis refer to the parts list and Figure 1.

Remove snap rings, outer washers, and barrel at pivot. Replace with pin (1) and bolt (2) as shown in Figure 1. If necessary, add shims (3) between pedal arm and base to reduce side to side movement of pedal arm, see Figure 1. Torque bolt (2) to 180 in-lbs.

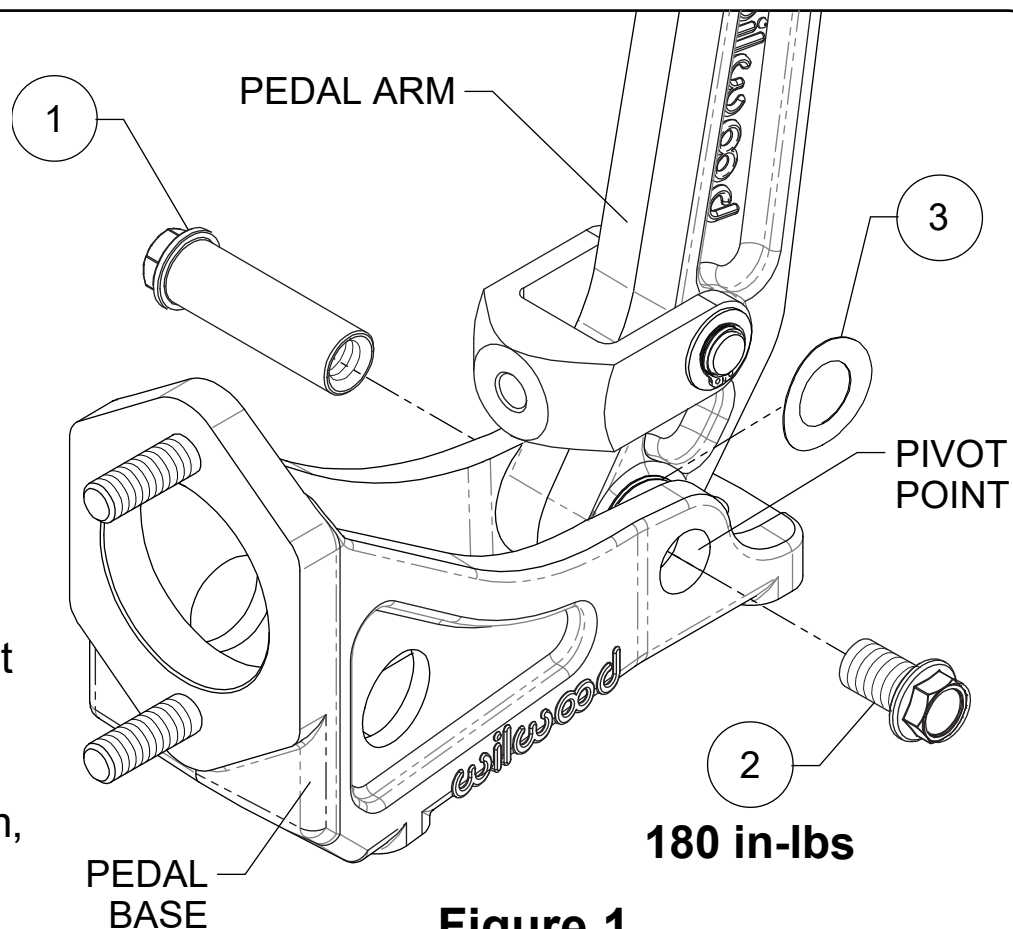

Figure 1.

PARTS LIST

<u>ITEM NO.</u>	<u>PART NO.</u>	<u>DESCRIPTION</u>	<u>QTY</u>
1	230-16075	Pin, 3/8-16, .50" O.D. x 1.60" Long	1
2	230-16076	Bolt, 3/8-16 x .63" Long, 6 Point Hex Head	1
3	240-16613	Shim, Wave, .010" Thick	4