

MITSUBISHI EVO VIII PRO-MATRIX PERFORMANCE PAD AND ROTOR KIT

Models Covered:

EVO VIII

2003 - 2005

Kit Features:

- Direct replacement performance upgrade for OE front rotors, pads, and flexlines
- Full bolt-on installation retains use of all other factory components and ABS
- Reduces over 9 pounds of rotating weight while increasing cooling capacity and stopping power

Component Features:

GT-48 Directional Vane Rotors

- Premium grade GT series rotors with thick wall sections and 48 directional cooling vanes provide high cooling efficiency and structural stability in the toughest environments.
- Asymmetrical face slots reduce engagement harmonics, improve thermal balance, and benefit pad performance through degassing and surface cleaning.
- Full detail machining eliminates stress points and unnecessary weight.
- Precision machining to less than .001 variation for flatness, parallelism, and overall run-out provides truest running with reduced knock back and positive pedal response.
- Individual dynamic balancing assures vibration free operation at all speeds.
- Bolt-on design allows use of aluminum mounting hats.

GT Rotor Hats

- Premium aluminum alloy hats are lightweight and provide sturdy mounting of the GT-48 rotors onto the OE hub assemblies.
- High luster black anodized finish resists corrosion and enhances the appearance inside the wheel.

Wilwood Pro-Matrix Pad Sets

- Performance compound pads deliver an ideal balance for street performance and amateur track day competitions.
- Balanced cold to hot friction with aggressive stopping power and heat resistance up to 850° F.
- Rotor friendly with lower noise and dust than comparable race compounds for comfortable driving and easy maintenance in light duty conditions.
- Wilwood also offers upgrade brake pads for the rear (sold separately) to compliment the front.

Hardware and Plumbing

- Stainless steel rotor bolts feature 12 point, lock-wire drilled heads for secure mounting in severe conditions.
- DOT approved stainless steel reinforced flex lines provide improved system response by eliminating line swell at the higher pressures while adding a customized look to the suspension elements.
- Stainless steel flex lines are also available for the rear (sold separately) to improve overall performance of the brake system.



Mitsubishi EVO VIII Pro-Matrix Upgrade Kit with GT Rotor

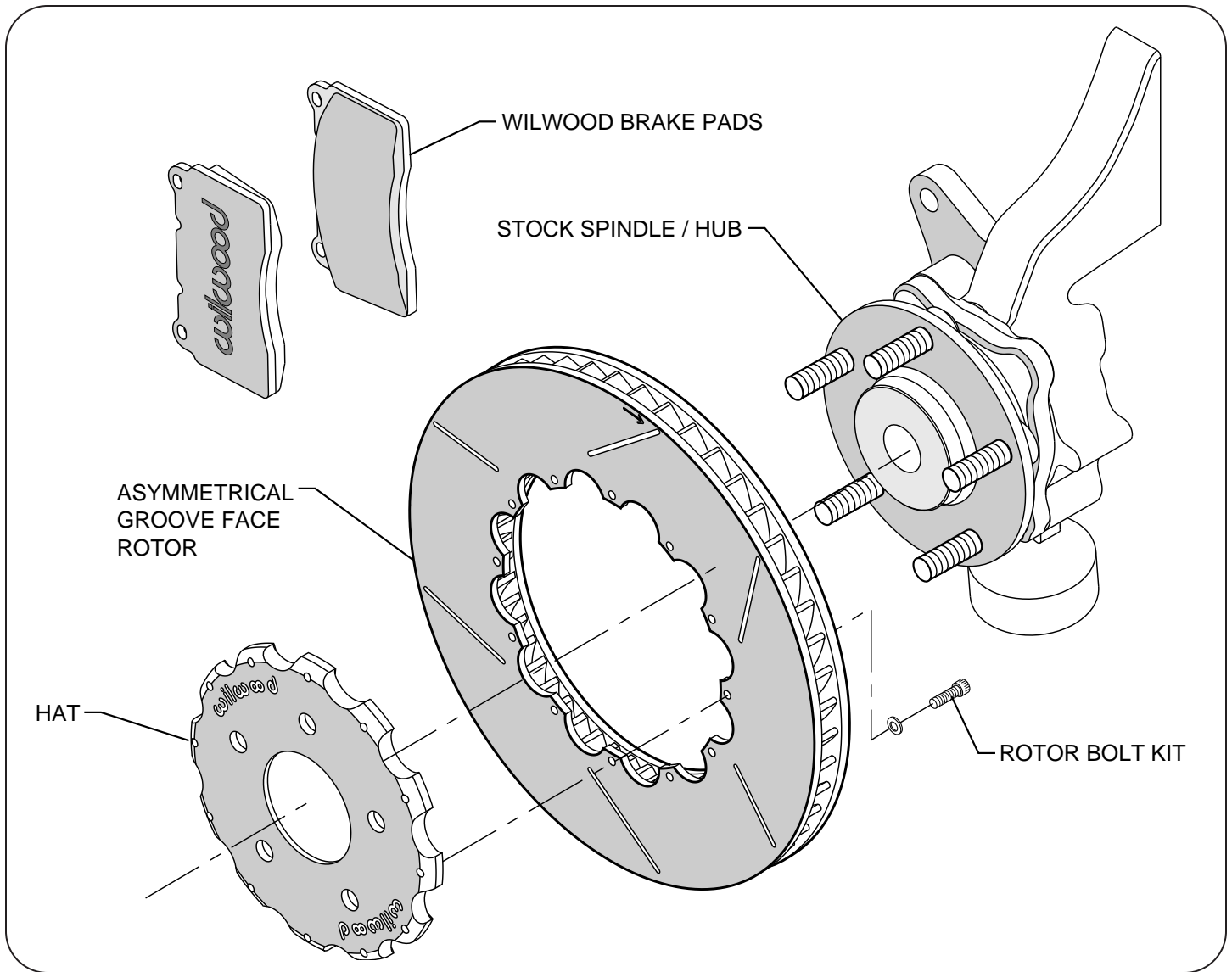

Typical Installation Diagram, Major Components Identified

ORDERING INFORMATION: BRAKE AND FLEX LINE KITS:

<u>MAKE / MODEL</u>	<u>YEAR</u>	<u>GT ROTOR KIT</u>	<u>FLEX LINE KITS</u>
Mitsubishi EVO VIII	2003 - 2005	140-8805	220-8806 ⁽¹⁾

Notes:

- (1) Flex line kit 220-8806 is included in the front kit, P/N 140-8805
- (2) Stainless steel flex line kits are available for the rear (must be ordered separately) - P/N 220-8934

ORDERING INFORMATION: USER SERVICEABLE COMPONENTS, PART NUMBER:

<u>KIT NUMBER</u>	<u>PAD SET</u>	<u>ROTOR</u>	<u>HAT</u>	<u>ROTOR BOLT KIT</u>	<u>BRAKE FLUID EXP - BOTTLE</u>	<u>INSTALLATION SHEET</u>
140-8805	150-D1001K	160-8746/47	170-8750	230-8008	290-6209	DS-501

Note:

- (1) Upgrade brake pads are available for the rear (must be ordered separately) - P/N 150-8970K