

wilwood

DISC BRAKES

GM A / G-BODY & S10 TRUCK

1978-1988

AERO6 BIG BRAKE KITS

1978-88 A / G-Body & 1982-04 S10 Truck

Now it is easy to give popular vehicles like the Chevy Monte Carlo SS and Buick Grand National the braking capacity needed to match upgraded handling and power. Aero6 big brake kits feature Aerolite calipers and huge rotors for 1978-1988 GM A/G-body "metric chassis," and 1982-2004 S10/S15 Sonoma pickups and S10 Blazer/Jimmy SUVs.



Engineered for heavy, high-powered vehicles and high-speed street or track use.

- Stress-flow forged aluminum Aerolite calipers with six differential bore pistons for more even clamping
- Closed bridge and finite element analysis design eliminates caliper deflection and transmits more force to the pads
- Big 14.00" x 1.25" vented rotors with 72 directional vanes to shed heat
- Fits most 18" wheels and larger
- Proprietary **Spec37** iron alloy with greater friction and increased thermal stability
- Lightweight forged aluminum mounting hats and billet hubs
- Choose GT slotted or SRP drilled and slotted rotors
- Calipers available in gloss black and red powder coat, or 22 additional color options (additional charges may apply)
- High-performance, fade-resistant **SmartPad** BP-20 compound brake pads included (additional compounds available for different uses)

Aero6 Big Brake Kits



Aerolite 14.00" Big Brake Kit
P/N 140-16246-DR (G-Body)

**24 COLOR
OPTIONS
AVAILABLE**
Additional charges may apply



wilwood

DISC BRAKES

GM A / G-BODY & S10 TRUCK

1978-1988

AERO6 BIG BRAKE KITS

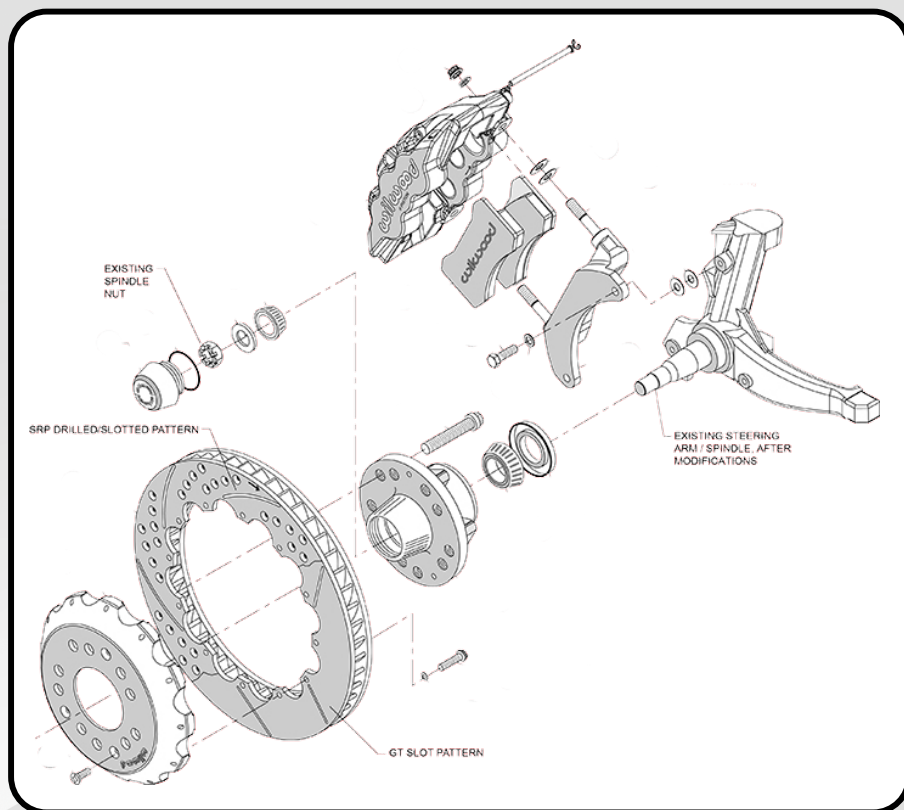

Aero6 Big Brake Kits for GM

1978-88 A / G-Body
&
1982-04 S10 Truck



P/N 140-16246



P/N 140-16246-R



P/N 140-16246-D



P/N 140-16246-DR

ORDERING INFO: PH: 805.388.1188 • FAX: 805.388.4938 • wilwood.com • info@wilwood.com

PART NUMBER	DESCRIPTION	CALIPER TYPE	CALIPER FINISH	ROTOR SIZE	ROTOR TYPE
140-16246	Forged 6 Piston Aerolite Caliper, GT 72 Vane Vented Slotted Rotor	Aerolite AERO6	Black Powder Coat	14.00" x 1.25"	GT Slotted
140-16246-R	Forged 6 Piston Aerolite Caliper, GT 72 Vane Vented Slotted Rotor	Aerolite AERO6	Red Powder Coat	14.00" x 1.25"	GT Slotted
140-16246-D	Forged 6 Piston Aerolite Caliper, SRP 72 Vane Vented Drilled & Slotted Rotor	Aerolite AERO6	Black Powder Coat	14.00" x 1.25"	SRP Drilled & Slotted
140-16246-DR	Forged 6 Piston Aerolite Caliper, SRP 72 Vane Vented Drilled & Slotted Rotor	Aerolite AERO6	Red Powder Coat	14.00" x 1.25"	SRP Drilled & Slotted