

1966-77 FORD BRONCO FNLS4R REAR PARKING BRAKE KITS

Kit Features:

- Compatible with Small, Big, and Big Bearing New Style Ford Broncos, 5 x 5.50" bolt circle.
- Upgrade from Original Equipment (OE) brakes to four piston Forged Superlite 4 Radial Mount calipers.
- 12.88" or 14.00" diameter in either GT slotted, or SRP drilled and slotted.
- Simple bolt-on installation with no modifications required.
- 12.88" diameter kits fit most 17" wheels; 14.00" diameter kits fit most 18" and larger wheels. Check www.wilwood.com for specific wheel clearance requirements.

Component Features:

Calipers

- FNLS4R Radial Mount four Piston Calipers
- Competition proven forged billet aluminum bodies demonstrate superior strength and resistance to deflection and separation under high load.
- Four symmetrical bore pistons generate high clamping force for optimized stopping power.
- Stainless steel pistons resist corrosion while slowing the heat transfer rate from the pads to the caliper body, fluid and seals.
- The caliper's seal-in-bore design adds proven durability, keeping the fluid in and dirt out without the need for external boot seals.
- Spring loaded stainless steel SRS bridge plates dampen pad noise and protect the caliper bridges from wear.
- Calipers provide easy access to the pads for service, without the need to unbolt the calipers from their mounts.
- Calipers are available with either black or red high-gloss, high temperature, brake fluid resistant sealed powder coat and feature Wilwood's signature logo. "Quick-Silver" finish calipers are also available by special order.

Rotors (12.88" x 1.25" or 14.00" x 1.25")

- GT competition series rotors feature full detail machining with asymmetrical slots in the faces. GT rotors provide the highest degree of durability and longer life for repeated hard braking and high temperature use.
- SRP rotors feature our signature performance drilled and slotted pattern with a durable e-coat finish. E-coat seals the casting and prevents corrosion in all areas of the rotor not swept clean by the brake pads. This resilient finish will maintain the high tech styling and appearance of the rotors inside your wheels for many miles down the road.
- Rotors are mated to specially machined iron hats that act as the drum for the parking brake assembly. Hats are black E-coat finished to resist corrosion while adding to the aggressive competition look inside the wheel.

Parking Brake

- The drum style internal parking brake provides outstanding holding power with the ultimate uncluttered custom look.
- The two shoe system is mechanically actuated and spring loaded for quiet non-rattling performance.
- Brake shoes are neatly hidden and out-of-sight inside the rotor hat assembly. Parking brake cables are relocated inward with more clearance for deep offset wheels.

Brake Pads

- Kits include our proven formula BP-10 Smart Pads. BP-10 is a unique composite-metallic compound that provides increased friction, stopping power, and higher fade resistance in a clean and quiet-running, low-dust style pad.
- Optional high-temperature and race-only pad compounds are also available.

Hardware

- Radial mounting provides secure attachment with two planes of adjustment for precise alignment of the caliper over the rotor. Caliper brackets, premium grade hardware, and detailed installation instructions are included in every kit.
- Jacketed stainless steel braided, DOT approved flexlines are included.

Note:

- Clevis and cable kits, which attach to the parking brake assembly, are not included in the Wilwood parking brake kits. Wilwood offers a universal style cable kit for this vehicle, order part number 330-9371. Please visit our web site at www.wilwood.com, or call (805) 388-1188 for additional information.



FNLS4R SRP Kit Assembly
([download high-res photo](#)) **

PLEASE CHECK
 WILWOOD ALWAYS RECOMMENDS CHECKING THEIR WEBSITE, www.wilwood.com FOR COMPLETE YEAR/MAKE/MODEL APPLICATION DATA AND SPECIFIC WHEEL CLEARANCE REQUIREMENTS.

PLEASE VERIFY
 BEFORE ORDERING REAR AXLE BRAKE KITS, ALWAYS VERIFY HOUSING FLANGE PATTERN AND AXLE OFFSET DIMENSION AT www.wilwood.com

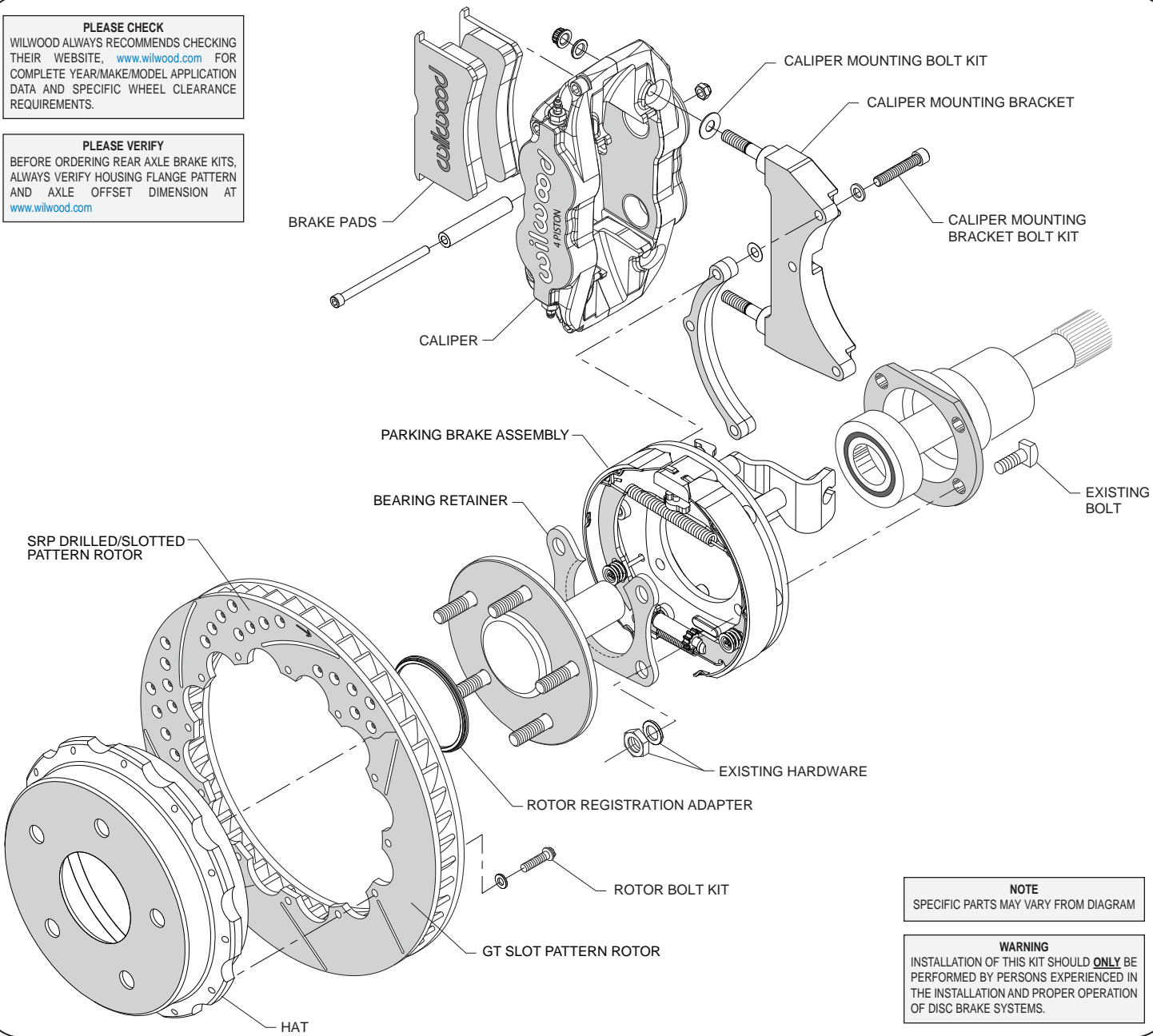

NOTE
 SPECIFIC PARTS MAY VARY FROM DIAGRAM

WARNING
 INSTALLATION OF THIS KIT SHOULD **ONLY** BE PERFORMED BY PERSONS EXPERIENCED IN THE INSTALLATION AND PROPER OPERATION OF DISC BRAKE SYSTEMS.

Typical Installation Diagram (12.88" FNSL4R Kit Shown)

Due to the interchangeability of rear ends, please verify the Rear End Housing Flange and Axle Offset from the diagram below, or go to www.wilwood.com for a complete rear end / axle housing listing.

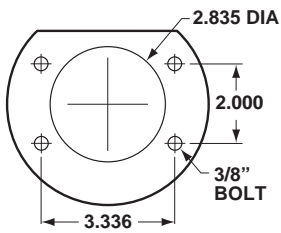

SMALL FORD

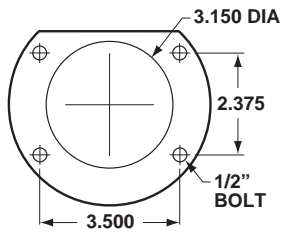

BIG FORD

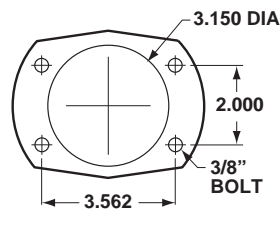

**BIG FORD
 (NEW STYLE)**

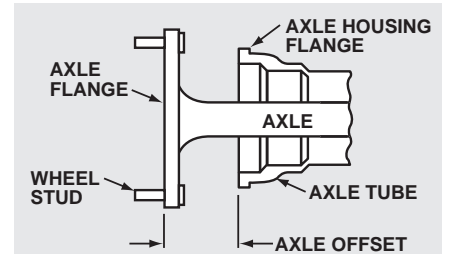

AXLE FLANGE CROSS-SECTION

Bronco Housing Flange / Axle Offset

ORDERING INFORMATION:

PART NUMBER

DESCRIPTION

140-13321	Small Bearing Ford, 2.36" Offset, 5 x 5.50" BC, FNLSL4R Caliper, 12.88" GT Rotor, Black Caliper
140-13321-D	Small Bearing Ford, 2.36" Offset, 5 x 5.50" BC, FNLSL4R Caliper, 12.88" SRP Drilled and Slotted Rotor, Black Caliper
140-13321-R	Small Bearing Ford, 2.36" Offset, 5 x 5.50" BC, FNLSL4R Caliper, 12.88" GT Rotor, Red Caliper
140-13321DR	Small Bearing Ford, 2.36" Offset, 5 x 5.50" BC, FNLSL4R Caliper, 12.88" SRP Drilled and Slotted Rotor, Red Caliper
140-13332	Small Bearing Ford, 2.36" Offset, 5 x 5.50" BC, FNLSL4R Caliper, 14.00" GT Rotor, Black Caliper
140-13332-D	Small Bearing Ford, 2.36" Offset, 5 x 5.50" BC, FNLSL4R Caliper, 14.00" SRP Drilled and Slotted Rotor, Black Caliper
140-13332-R	Small Bearing Ford, 2.36" Offset, 5 x 5.50" BC, FNLSL4R Caliper, 14.00" GT Rotor, Red Caliper
140-13332-DR	Small Bearing Ford, 2.36" Offset, 5 x 5.50" BC, FNLSL4R Caliper, 14.00" SRP Drilled and Slotted Rotor, Red Caliper
140-13323	Big Bearing Ford, 2.36" Offset, 5 x 5.50" BC, FNLSL4R Caliper, 12.88" GT Rotor, Black Caliper
140-13323-D	Big Bearing Ford, 2.36" Offset, 5 x 5.50" BC, FNLSL4R Caliper, 12.88" SRP Drilled and Slotted Rotor, Black Caliper
140-13323-R	Big Bearing Ford, 2.36" Offset, 5 x 5.50" BC, FNLSL4R Caliper, 12.88" GT Rotor, Red Caliper
140-13323-DR	Big Bearing Ford, 2.36" Offset, 5 x 5.50" BC, FNLSL4R Caliper, 12.88" SRP Drilled and Slotted Rotor, Red Caliper
140-13333	Big Bearing Ford, 2.36" Offset, 5 x 5.50" BC, FNLSL4R Caliper, 14.00" GT Rotor, Black Caliper
140-13333-D	Big Bearing Ford, 2.36" Offset, 5 x 5.50" BC, FNLSL4R Caliper, 14.00" SRP Drilled and Slotted Rotor, Black Caliper
140-13333-R	Big Bearing Ford, 2.36" Offset, 5 x 5.50" BC, FNLSL4R Caliper, 14.00" GT Rotor, Red Caliper
140-13333-DR	Big Bearing Ford, 2.36" Offset, 5 x 5.50" BC, FNLSL4R Caliper, 14.00" SRP Drilled and Slotted Rotor, Red Caliper
140-13734	Big Bearing Ford, 2.00" Offset, 5 x 5.50" BC, FNLSL4R Caliper, 12.88" GT Rotor, Black Caliper
140-13734-D	Big Bearing Ford, 2.00" Offset, 5 x 5.50" BC, FNLSL4R Caliper, 12.88" SRP Drilled and Slotted Rotor, Black Caliper
140-13734-R	Big Bearing Ford, 2.00" Offset, 5 x 5.50" BC, FNLSL4R Caliper, 12.88" GT Rotor, Red Caliper
140-13734-DR	Big Bearing Ford, 2.00" Offset, 5 x 5.50" BC, FNLSL4R Caliper, 12.88" SRP Drilled and Slotted Rotor, Red Caliper
140-13731	Big Bearing Ford, 2.00" Offset, 5 x 5.50" BC, FNLSL4R Caliper, 14.00" GT Rotor, Black Caliper
140-13731-D	Big Bearing Ford, 2.00" Offset, 5 x 5.50" BC, FNLSL4R Caliper, 14.00" SRP Drilled and Slotted Rotor, Black Caliper
140-13731-R	Big Bearing Ford, 2.00" Offset, 5 x 5.50" BC, FNLSL4R Caliper, 14.00" GT Rotor, Red Caliper
140-13731-DR	Big Bearing Ford, 2.00" Offset, 5 x 5.50" BC, FNLSL4R Caliper, 14.00" SRP Drilled and Slotted Rotor, Red Caliper
140-13665	Big Bearing Ford, New Style, 2.38" Offset, 5 x 5.50" BC, FNLSL4R Caliper, 12.88" GT Rotor, Black Caliper
140-13665-D	Big Bearing Ford, New Style, 2.38" Offset, 5 x 5.50" BC, FNLSL4R Caliper, 12.88" SRP Drilled and Slotted Rotor, Black Caliper
140-13665-R	Big Bearing Ford, New Style, 2.38" Offset, 5 x 5.50" BC, FNLSL4R Caliper, 12.88" GT Rotor, Red Caliper
140-13665-DR	Big Bearing Ford, New Style, 2.38" Offset, 5 x 5.50" BC, FNLSL4R Caliper, 12.88" SRP Drilled and Slotted Rotor, Red Caliper
140-13666	Big Bearing Ford, New Style, 2.38" Offset, 5 x 5.50" BC, FNLSL4R Caliper, 14.00" GT Rotor, Black Caliper
140-13666-D	Big Bearing Ford, New Style, 2.38" Offset, 5 x 5.50" BC, FNLSL4R Caliper, 14.00" SRP Drilled and Slotted Rotor, Black Caliper
140-13666-R	Big Bearing Ford, New Style, 2.38" Offset, 5 x 5.50" BC, FNLSL4R Caliper, 14.00" GT Rotor, Red Caliper
140-13666-DR	Big Bearing Ford, New Style, 2.38" Offset, 5 x 5.50" BC, FNLSL4R Caliper, 14.00" SRP Drilled and Slotted Rotor, Red Caliper



Need additional information - fast? Utilizing your Smartphone, scan the image at the left to jump to our web site. This code takes you to our home page and social media sites where information is just a click away, [or click here.](#)