

## GN4R/ST 4 PISTON - LUG DRIVE / DYNAMIC MOUNT S197 MUSTANG ROAD RACE FRONT BRAKES

Wilwood's Grand National GN 4R/ST four piston racing calipers are combined with 13.00" dynamic-mount, lug-drive rotors to create the ultimate high-capacity, road race brake package for fitment with most 17" wheels. This configuration meets all current SCCA American Sedan specifications, and is well suited to NASA and most other popular sanctions competing with OE production S197 Mustang front spindles.



### KIT FEATURES:

- Complete bolt-on installation when using the OE S197 front spindles and hubs; no modifications are required
- Best option for cars converted to dual circuit, manual or balance bar racing brake pedals

### CALIPERS: GN4R/ST

- Super high-strength and rigidity forged billet aluminum caliper body with Type III Mil-Spec hard-anodized surfaces resists deflection, bore wear, and abrasion of all kinds
- Differential bore, four piston "ST" model includes Thermlock thermal barrier pistons providing up to 25% cooler caliper operating temperatures; piston damper springs included

### LUG-DRIVE ROTORS: **Spec37** GT-48 DIRECTIONAL VANE

- Dynamic-mount lug-drive system provides full isolation of thermally induced stresses between the hat and rotor
- The drive lug and snap-ring system completely eliminates any type of rotor bolt or bobbin
- No longer need safety wire, thread lockers, or torque wrenches, and new rotors can be re-assembled in under one minute

### BRAKE PADS: BP-30, TYPE 7520-30

- BP-30 race compound **SmartPads** provide smooth, and consistent response with high friction and long wear over a broad range of temperatures and traction conditions.

### INSTALLATION PARTS:

- Caliper brackets, stainless steel braided brake hoses, and all premium grade hardware for installation are included.



[P/N 140-16666](#)

### Dynamic Mount Lug-Drive Technology

**Spec37** Alloy GT-48  
Directional Vane Rotors

Forged Aluminum  
Hats with Hard  
Anodized Finish

Snap  
Ring

Stainless Steel  
Anti-Rattle Wear Plates

#### Wheel Clearance Diagram

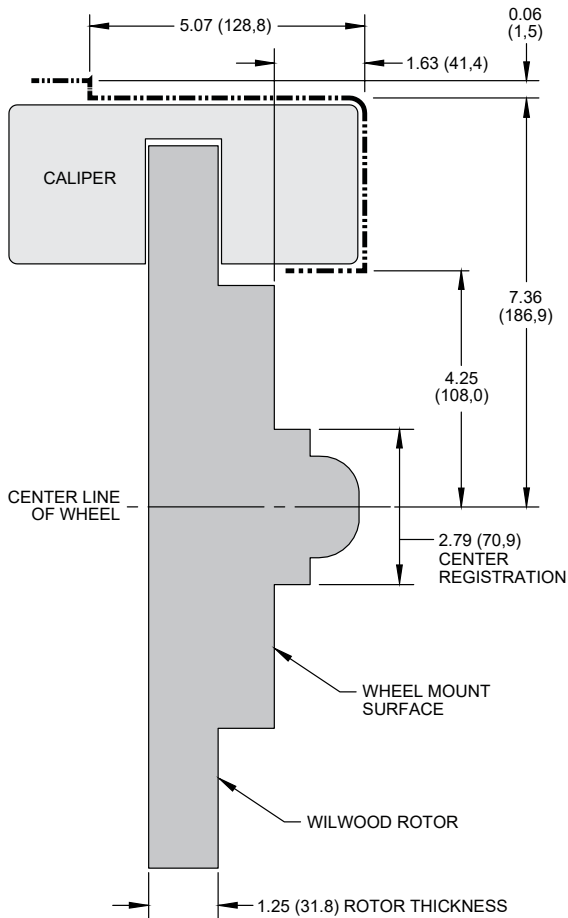

NOTE: A MINIMUM OF .080" CLEARANCE MUST BE MAINTAINED BETWEEN THE WHEEL AND CALIPER IN ALL AREAS

#### Typical Installation Diagram

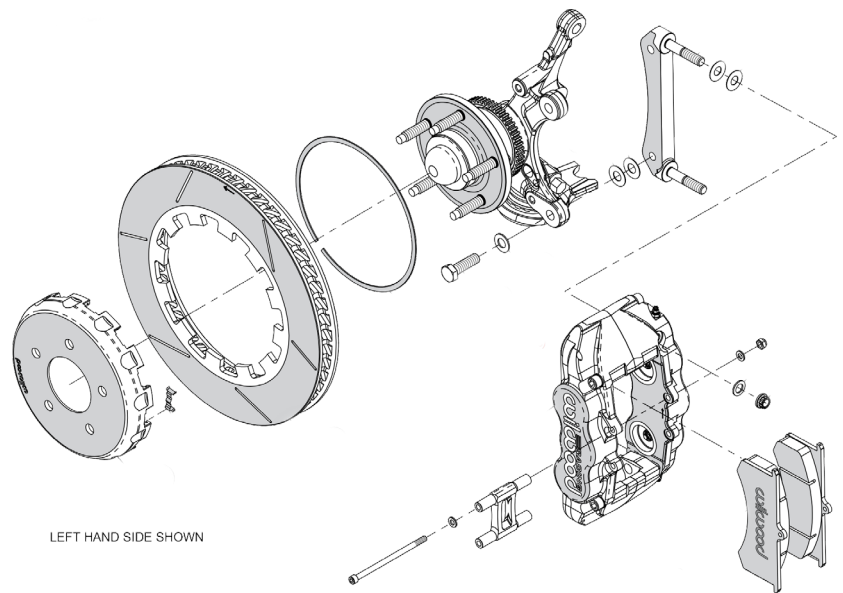

ORDERING INFORMATION: PH: 805.388.1188 • FAX: 805.388.4938 • [wilwood.com](http://wilwood.com) • [info@wilwood.com](mailto:info@wilwood.com)

PART NUMBER	DESCRIPTION	CALIPER TYPE	CALIPER FINISH	ROTOR TYPE	ROTOR SIZE
<a href="#">140-16666</a>	Kit, Front Road Race, Mustang 05-14	GN4R/ST	Hard Anodized Gray	Spec37 GT-48 Lug Drive	13.00" x 1.25" (330mm x 32mm)

#### ACCESSORIES

PART NUMBER	DESCRIPTION
<a href="#">290-6209</a>	EXP600 Plus, DOT 4 Racing Brake Fluid, 16.9oz bottle
<a href="#">290-8478</a>	EXP600 Plus, DOT 4 Racing Brake Fluid, 16.9oz bottle, 6 pack
<a href="#">290-16353</a>	XR Race Only Brake Fluid, 16.9 oz can
<a href="#">290-16354</a>	XR Race Only Brake Fluid, 16.9 oz can, 4 pack