

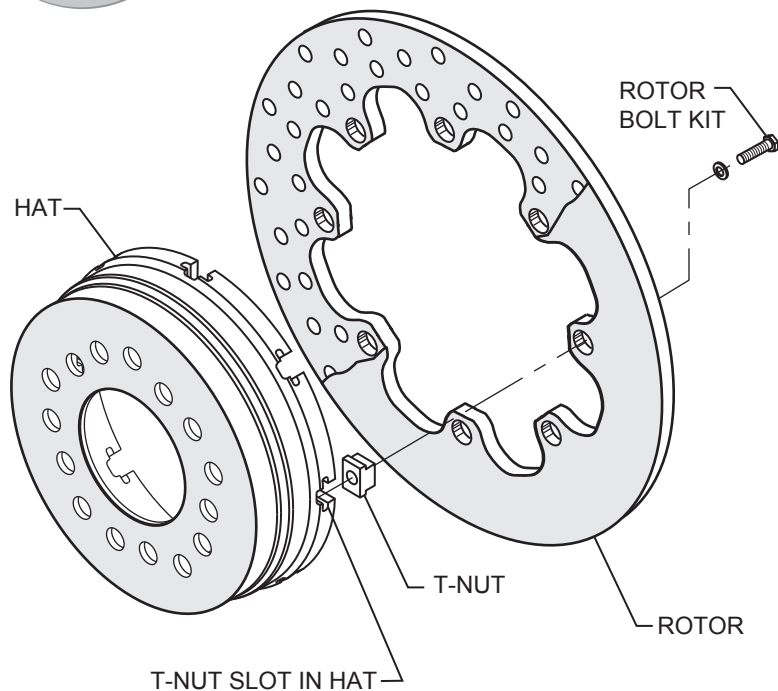

## DYNAMIC MOUNT HAT / T-NUT INSTALLATION INSTRUCTIONS



**HAT, ROTOR, T-NUT INSTALLATION DIAGRAM**

### PROCEDURE

Slide the T-nuts into the "T" slots in the hat, as shown in the top diagram at left. Attach the hat to the rotor using washers and bolts supplied in the rotor bolt kit. Finger tighten.

One at a time using an alternating sequence, insert the T-nut tool (supplied in the rotor bolt kit) into the slot between the T-nut and hat up to the flat spot on the T-nut tool shaft, as shown in the bottom diagram at left. Remove bolt, apply red *Loctite*<sup>®</sup> 271 to the threads, and torque to 198 in-lb.

Safety wiring rotor bolts as outlined in the installation procedure is highly recommended.

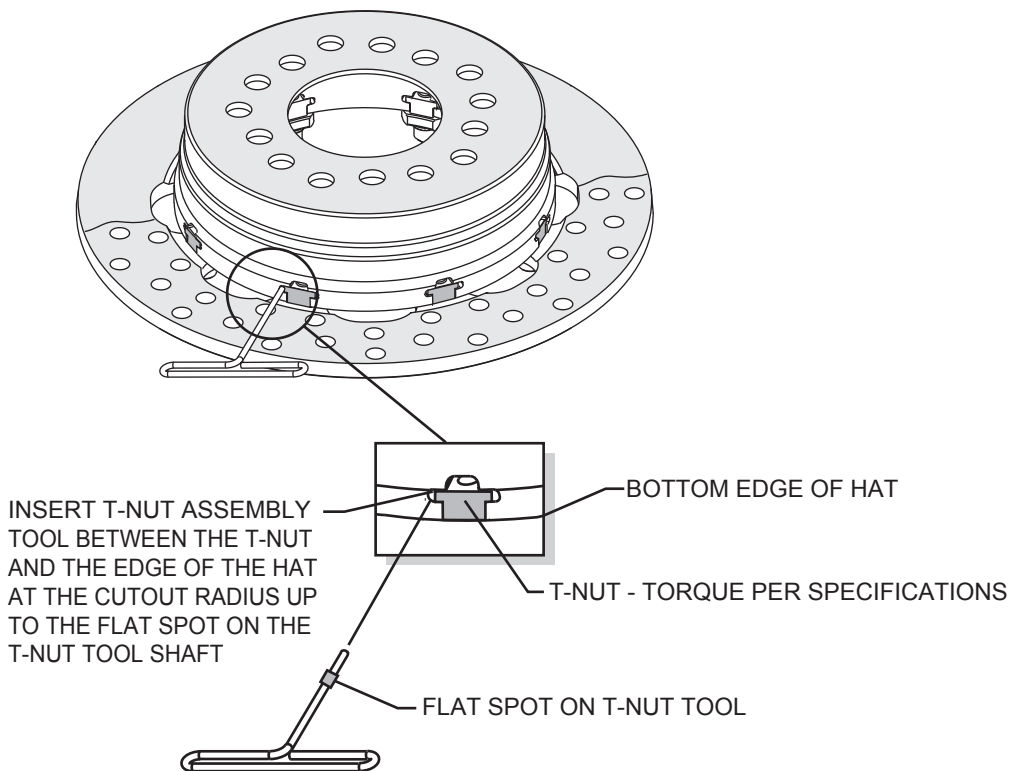

**T-NUT ASSEMBLY TOOL USAGE DIAGRAM**