

# CHEVY/GMC SUV AND 1500 SERIES TRUCK SL4R PRO SERIES REAR DISC BRAKE KIT

## Models Covered:

All models with 6 lug wheels

1999 - Present

## Kit Features:

- Matched rear braking for TC 6 Front Big Brake Kits
- Full bolt-on installation for vehicles originally equipped with rear discs
- Retains use of factory park brake assembly
- Compatible with ABS and OE master cylinder output
- Designed for use on custom / modified vehicles with oversized wheel and tire upgrades (See clearance diagram on the back of this page)

## Component Features:

### Forged Billet SL4R Calipers

- Forged billet Superlite four piston radial mount calipers, available in red or black, provide superior strength and generate high clamping force from four dust boot captured pistons.
- Five, high strength alloy, steel cross-bridge bolts control caliper body separation and deflection under heavy loads. The center bridge bolt design provides easy access for pad service without caliper removal.
- Stainless steel SRS bridge plates reduce noise, dampen pad rattle, and eliminate bridge wear from pad load under braking.
- Radial mounting provides secure attachment with two adjustment planes for precise caliper alignment over the rotor.

### SRP or GT Disc / Drum 12.75" Vented Rotors

- Bigger diameter rotors provide added leverage to increase overall stopping power.
- One-piece vented disc/drum design, with internal cooling vanes, promotes rapid heat dispersion during braking, and a sturdy contact drum for the OE internal parking brake shoes.
- SRP disc / drum rotors feature an aggressive high-tech look, with an engineered directional drill and slot pattern, that benefits pad performance by reducing pad glazing and dispersing the gasses and some of the heat generated during braking. The rotors are finished with an e-coating to retard corrosion and enhance the complete custom look inside the wheels.
- GT disc/drum rotors are based on Wilwood's full competition style GT race rotor preparation. Asymmetrical face slotting, and precision detail machining with tolerances held under .001" for flatness, parallelism, and overall run-out, assure consistent pad response and smooth operation with the highest level of durability. The additional mass of this non-cross drilled version delivers improved thermal stability and is preferred for heavy load, sustained high temperature applications

### Wilwood Brake Pads

- High performance Wilwood brake pads are formulated with high friction values for increased stopping power and extended temperature range with the lowest dust and noise levels available from a performance compound pad.

### Mounting Hardware and Plumbing

- Steel radial mount caliper brackets are CNC machined for precise fit and secure attachment to the OE axle housing. Premium grade studs, nuts, bolts, washers, and alignment shims are included.
- Stainless steel reinforced flex-line kits, with machine crimped ends, can be ordered separately to complete the installation and add to the custom detail of the suspension. "AN" style flex-lines provide improved pedal feel with quicker system response by minimizing the compliance or "swell" that can occur with OE rubber lines.



GM Truck / SUV Pro Series  
Rear Kit with SRP Rotor

Please check the diagram on the back of this page for minimum inside wheel clearance requirements

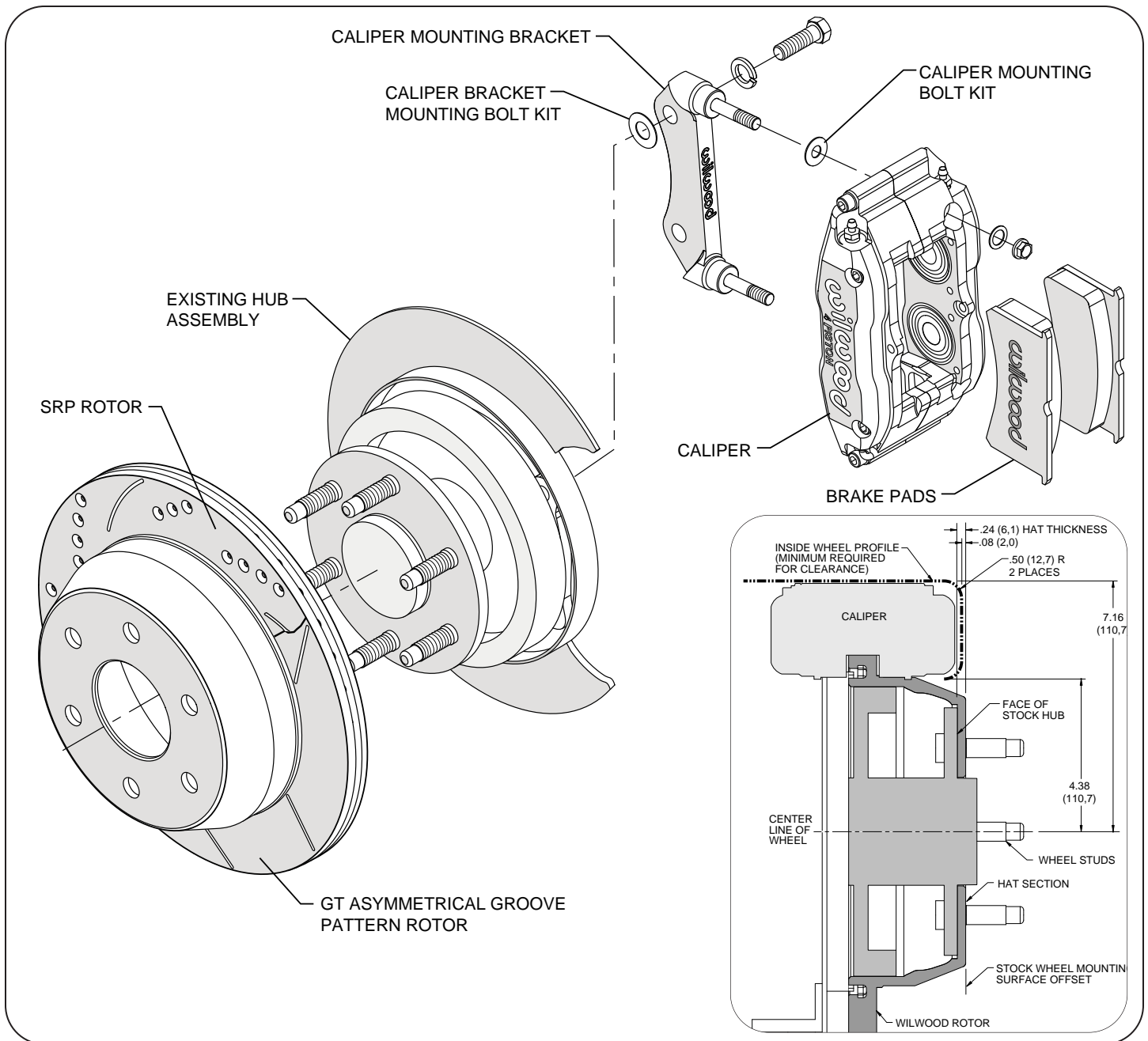

Typical Installation Diagram, Major Components Identified. Minimum Wheel Fit Dimensions Shown Inset

**ORDERING INFORMATION: BRAKE AND FLEX LINE KITS:**

MAKE / MODEL	YEAR	GT ROTOR KIT	KIT PART NUMBERS <sup>(1)</sup>		
			SRP ROTOR KIT	FLEX LINE KITS	
All 6 lug models with single piston OE calipers	1999 - Present	140-8993	140-8993-D	220-8999	
All 6 lug models with dual piston OE calipers	1999 - Present	140-9188	140-9188-D	220-8999	

Note: (1) Specify red caliper option by adding "R" to the end of the part number when ordering.

**ORDERING INFORMATION, COMPONENTS AND SERVICE PARTS:**

KIT NUMBER	BLACK CALIPER-R/L	RED CALIPER-R/L	GT ROTOR-R/L	SRP ROTOR-R/L	PAD AXLE SET	BRACKET KIT
140-8993-D/R	120-8064-R/L	120-8064-RRD / LRD	160-8957	160-8958/59	150-8855K	250-8963
140-9188-D/R	120-8070-R/L	120-8070-RRD / LRD	160-8957	160-8958/59	150-8855K	250-8963