



CAMARO REAR DISC KITS WITH PARKING BRAKE FOR STAGGERED MOUNT SHOCKS

Models Covered:

Camaro with OE staggered shock mounting on 1968 - 1981
leaf spring rear suspension

Kit Features:

- Designed as an upgrade from OE discs or as a conversion from OE drum brakes.
- Staggered caliper mounts eliminate all potential shock absorber clearance issues on vehicles equipped with OE configuration leaf spring rear suspensions.
- Full bolt-on installation kits available for OE Chevy 10-12 Bolt c-clip rear axles and custom rear axles built with new style Ford 9" housing ends.
- Compatible with OE and aftermarket disc brake master cylinders.

Component Features:

Forged Billet Dynalite Calipers

- High strength, FEA designed forged aluminum billet bodies provide the highest clamping efficiency and lowest deflection of any caliper in its class.
- Four stainless steel pistons generate high clamping force and balanced pad loading with low heat transfer and high resistance to corrosion.
- Spring loaded stainless steel SRS bridge plates reduce noise by damping engagement harmonics and eliminating pad rattle. SRS plates also extend caliper service life by eliminating bridge gouging at the pad trailing edge.
- Internal fluid passages eliminate all potential problems associated with external fluid transfer tubes.
- Four corner bleed screws accommodate effective gas evacuation regardless of mounting position.
- Top loaded pads are easily inspected and serviced with the need to remove the caliper from the mount.
- Standard kits include black calipers. Optional red or polished calipers are also available.

SRP or HP Series 12.19" Diameter Rotors

- 12.19" diameter vented iron discs provide high cooling efficiency and increased leverage for big brake stopping power inside 15" or larger wheels.
- SRP directional drilled and slotted rotors enhance pad performance with consistent response by cleaning and venting gasses, dust, and burnt pad material. A silver zinc finish is applied to resist corrosion and preserve the aggressive high-tech look inside the wheel.
- HP full surface rotors carry additional mass, without drilling or slotting, for maximum resistance against thermal stress and fatigue on heavy duty and sustained high heat competition applications.
- All SRP and HP rotors are close tolerance machined to less than .001" for total flatness, parallelism and run-out to assure true running at all speeds.

Wilwood BP-10 Compound High Performance "Smart Pads"

- BP-10 is an exclusive Wilwood metallic composite compound. This remarkable material possesses the quiet, low dusting properties found in ceramic based street compounds, but with the higher friction, heavier load capacity, and increased fade resistance of a medium range race pad.

Internal Shoe Parking Brake

- Cable actuated internal shoe assemblies are neatly hidden inside the drum of the one-piece rotor to provide outstanding holding power and a clean and uncluttered installation
- The factory pre-assembled shoe assemblies are spring loaded for positive release and rattle free operation.

Mounting Brackets and Hardware

- Integral mounting brackets secure the caliper and the parking brake assembly to the axle tube.
- High strength steel and performance grade nuts, bolts, and alignment shims are include to complete the secure and accurate installation.



Rear Parking Brake Kit
with SRP Rotor

Please check the diagram on the back of this page for minimum inside wheel clearance requirements

4700 Calle Bolero • Camarillo, CA 93012 • www.wilwood.com • Sales: (805) 388-1188 • E-mail Tech Assistance: support@wilwood.com

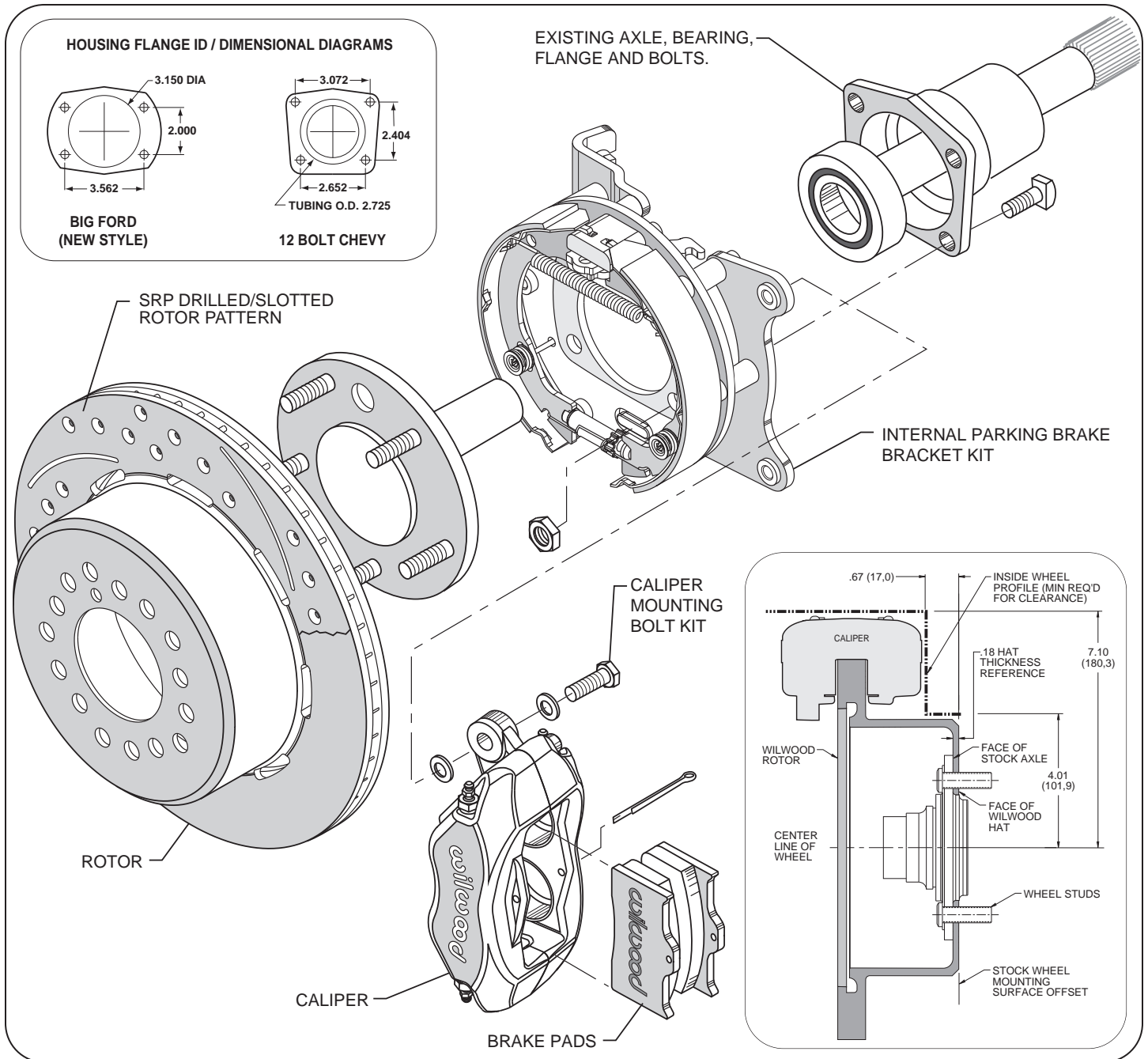

Typical Installation Diagram, Major Components Identified. Minimum Wheel Fit Dimensions Shown Lower Right Inset

ORDERING INFORMATION:

MAKE / MODEL	FLANGE OFFSET	KIT PART NUMBERS	
		HP ROTOR KIT	SRP ROTOR KIT
Chevy 10-12 Bolt C-Clip Axles	2.75"	140-9315	140-9315-D
Ford New Style 9" Axles	2.50"	140-9560	140-9560-D

ORDERING INFORMATION, COMPONENTS AND SERVICE PARTS:

BASE KIT NUMBER	CALIPER	HP ROTOR-R/L	SRP ROTOR-R/L	BRAKE PAD AXLE SET	PARKING BRAKE MOUNT BRACKET ASSEMBLY
140-9315	120-6806	160-9314	160-9317/18	150-8850K	249-7122/9316
140-9560	120-6806	160-6864	160-6968/69	150-8850K	249-7110/9559