

Big Brake Kits, Front & Rear for Classic **1970-76 Porsche 914**



If you're a Porsche 914 enthusiast, you already know that most of the cars you see nowadays have a lot more power than they started with. To complement the added power, they need upgraded brakes and Wilwood Disc Brakes has the perfect solution. Front and rear brake kits are now available for 1970-76 Porsche 914/4. Kits include forged aluminum **Powerlite** four piston calipers, brackets, and hubs, combined with larger, plain face or SRP drilled and slotted, vented rotors. Wilwood's brake kit upgrade weighs ~53% less than the smaller OE cast iron, unvented brakes. Reduced unsprung rotating mass is always the right choice. **Note: these brake kits MUST be used with a 914/6 or 911, 19mm master cylinder.**

BRAKE KITS FEATURE:

- Forged aluminum calipers are lighter and stiffer than cast iron, and have been proven over decades in countless road races, rally, and off-road competitions
- Aluminum mounting rotor adapters, brackets, and hubs make the kits substantially lighter than stock while increasing braking performance and stamina
- Wheel studs are included with the front kits (user supplies proper lug nuts for wheels being used)

CALIPERS: POWERLITE (PL4R)

- Rigid **Powerlite** four piston radial-mount calipers are engineered to improve braking performance and feature pistons sized to maintain the 914's proper front-to-rear brake bias
- Caliper profile allows fitment in many small diameter wheels, and quick-clip top pad retainer allows fast pad changes
- Calipers are finished in durable gloss red or gloss black powder coat, or 24 other color options (additional charges may apply)
- Rear kits include Wilwood's MC4 mechanical parking brake in left and right-hand configuration, plus the needed cable kit

ROTORS: **Spec37** Plain or SRP Drilled & Slotted

- Larger and thicker vented rotors provide greater brake torque and resist thermal distortion with curved vanes that circulate cooling air
- Both front and rear rotors are 289mm x 20mm (11.38"x0.81") premium proprietary **Spec37** iron alloy rotors with 36 curved vanes
- Both front and rear rotors are available in a precision plain face or SRP drilled and slotted pattern

BRAKE PADS: BP-10

- BP-10 street performance pads provide smooth and consistent response with long wear over a broad range of temperatures (other compounds available)

INSTALLATION PARTS:

- Kits include caliper brackets, Flexlines, and premium-grade installation hardware



Front,
Wheel
Studs
Included

Powerlite Front Complete Brake Kits

P/N: [140-17473](#) Plain or SRP Drilled & Slotted
Rotor, 11.38" x .81" (289 x 20mm)

See
Important
Notice Next
Page



Rear,
Park Brake
Included

Powerlite Rear Complete Brake Kits

P/N: [140-17475](#) Plain or SRP Drilled & Slotted
Rotor, 11.38" x .81" (289 x 20mm)

TYPICAL INSTALLATION CONFIGURATION - FRONT

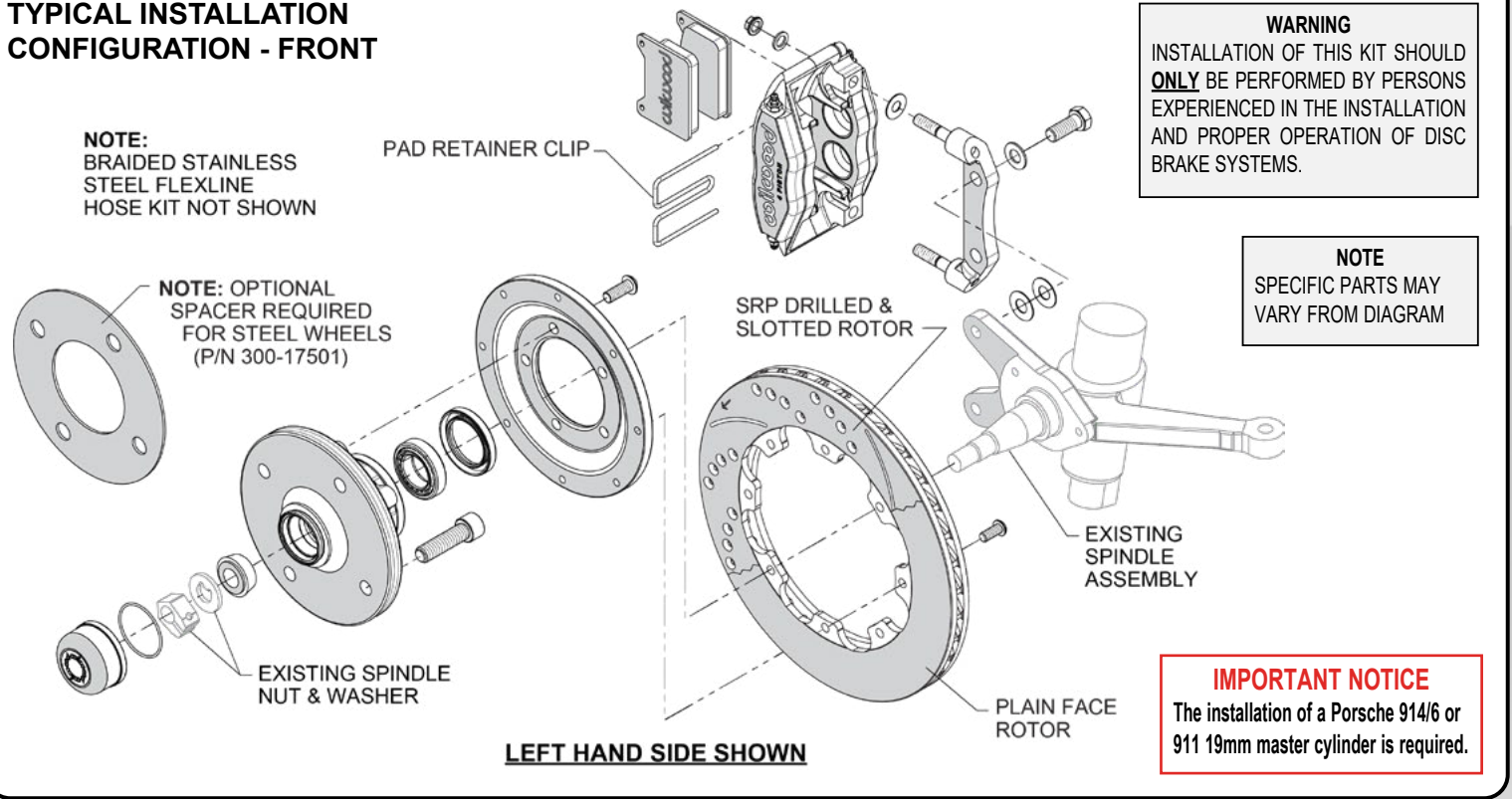

Precision Plain Face Rotors - Front



Precision Plain Face Rotors - Rear with Park Brake



SRP Drilled & Slotted Rotors - Front



SRP Drilled & Slotted Rotors - Rear with Park Brake

BRAKE KITS ORDERING INFO: PH: 805.388.1188 • FAX: 805.388.4938 • wilwood.com • info@wilwood.com

BLACK	RED	DESCRIPTION	CALIPER	ROTOR SIZE	ROTOR TYPE
140-17473	140-17473-R	Powerlite Front Kit, 1970-72	PL4R	11.38" x .81" (289mm x 20mm)	Plain Face
140-17473-D	140-17473-DR	Powerlite Front Kit, 1970-72	PL4R	11.38" x .81" (289mm x 20mm)	SRP Drilled & Slotted
140-17474	140-17474-R	Powerlite Front Kit, 1973-76	PL4R	11.38" x .81" (289mm x 20mm)	Plain Face
140-17474-D	140-17474-DR	Powerlite Front Kit, 1973-76	PL4R	11.38" x .81" (289mm x 20mm)	SRP Drilled & Slotted
140-17475	140-17475-R	Powerlite Rear Kit, 1970-76	PL4R	11.38" x .81" (289mm x 20mm)	Plain Face
140-17475-D	140-17475-DR	Powerlite Rear Kit, 1970-76	PL4R	11.38" x .81" (289mm x 20mm)	SRP Drilled & Slotted