

XRD CALIPER REAR DRAG RACE DYNAMIC MOUNT SCALLOPED BRAKE KITS

Wilwood has engineered updated rear axle drag race brake kits using new **XRD** calipers and 11.25" super alloy scalloped and drilled rotors in both single and dual caliper configurations. The kits are designed to be compatible with popular drag race rear axle flange types, including Ford New Style (2.50" offset), Ford Old Style (2.36" offset), Olds/Pontiac (2.81" offset), and LAMB/Mark Williams (2.81" offset).

Forged **XRD** caliper and **Lug-Drive** dynamic mount SA (Super Alloy) scalloped rotor rear brake kits are perfect for drag race cars with wider tires that rely heavily on the rear brakes for more stopping power. The 11.25" size rotor allows better clearance for use with typical 15" rear wheels.

KIT FEATURES:

- Single or dual hard anodized caliper kit options depending on vehicle weight and chassis setup
- Olds/Pontiac and LAMB/Mark Williams kits have options for both 1/2" and 11/16" wheel studs

CALIPERS: XRD

- Stress-flow forged aluminum **XRD** calipers feature the latest FEA (finite element analysis) computer design technology to shed weight while maintaining rigidity
- Type III hard anodize finish inside and out, including piston chambers, plus high-temperature seals

ROTORS: SA DYNAMIC MOUNT

- 11.25" x .35" Super Alloy scalloped, drilled steel rotors are lightweight and designed to handle heat spikes
- High resistance to thermal distortion with excellent pad friction characteristics

BRAKE PADS: BP-28

- Fade-resistant **BP-28** medium to high friction pad (additional compounds available)

INSTALLATION PARTS:

- Snap ring, rotor wear clips and premium-grade hardware included



SINGLE XRD CALIPER

(shown with 3 bolt patterns, 1/2" stud)



DUAL XRD CALIPERS

(shown with 2 bolt patterns, 11/16" stud)

TYPICAL INSTALLATION XRD REAR DRAG KITS SINGLE or DUAL CALIPER

WARNING
INSTALLATION OF THIS KIT SHOULD **ONLY** BE PERFORMED BY PERSONS EXPERIENCED IN THE INSTALLATION AND PROPER OPERATION OF DISC BRAKE SYSTEMS.

NOTE:
SPECIFIC PARTS MAY VARY FROM DIAGRAM

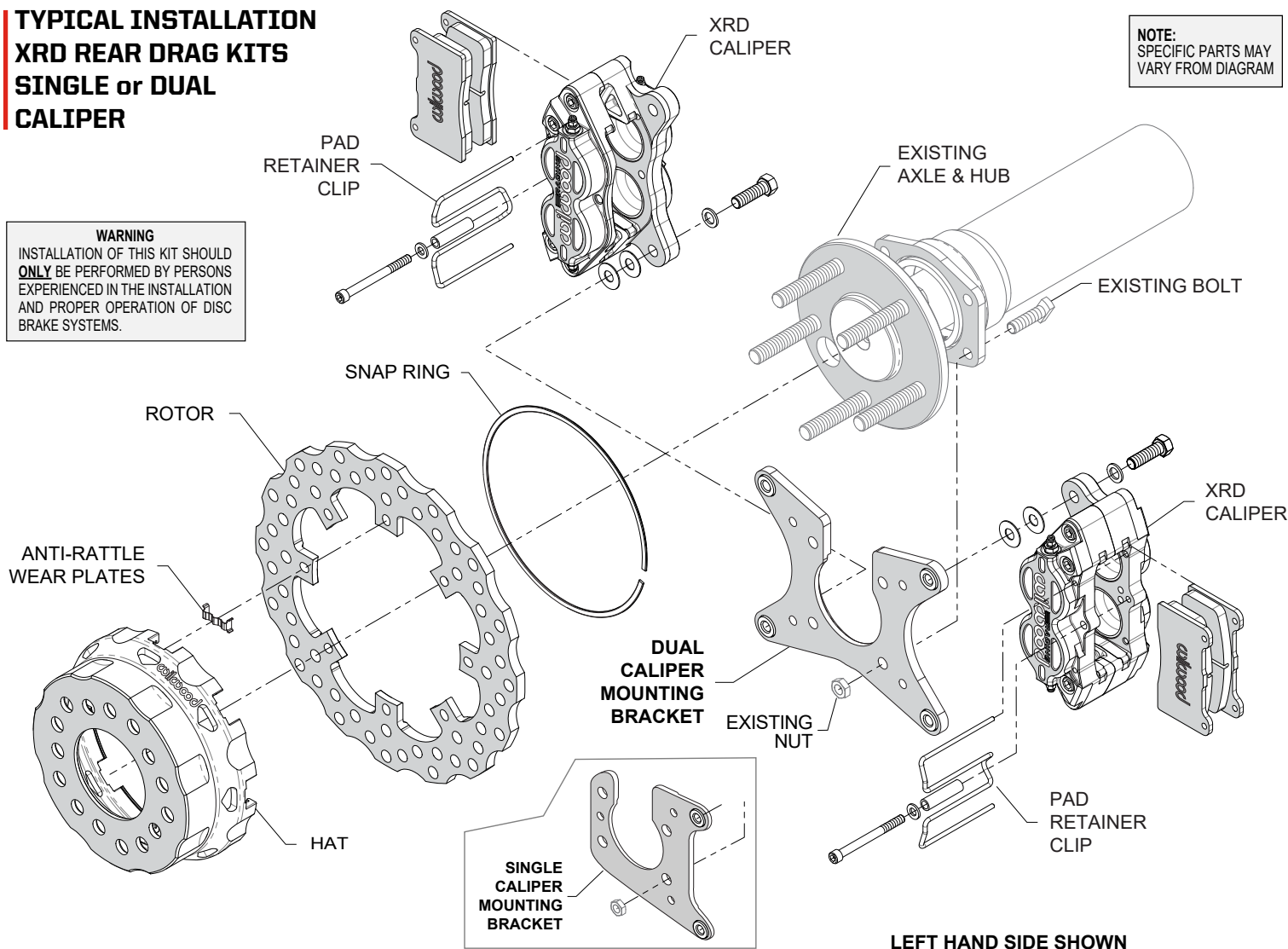

ORDERING INFO: PH: 805.388.1188 • FAX: 805.388.4938 • wilwood.com • info@wilwood.com

SINGLE	DUAL	DESCRIPTION	CALIPER TYPE	ROTOR TYPE	ROTOR SIZE
140-17873-D	140-17874-D	Drag Kit, Rear BIG FORD, NEW & OLD, 2.50" Offset	XRD Drag, Four Piston, Type III Ano	Scalloped, Drilled	11.25" x .35"
140-17875-D	140-17876-D	Drag Kit, Rear BIG FORD, NEW & OLD, 2.36" Offset	XRD Drag, Four Piston, Type III Ano	Scalloped, Drilled	11.25" x .35"
140-17877-D	140-17878-D	Drag Kit, Rear OLDS/PONTIAC, 2.81" Offset, 1/2" Stud Dia.	XRD Drag, Four Piston, Type III Ano	Scalloped, Drilled	11.25" x .35"
140-17879-D	140-17880-D	Drag Kit, Rear OLDS/PONTIAC, 2.81" Offset, 11/16" Stud Dia.	XRD Drag, Four Piston, Type III Ano	Scalloped, Drilled	11.25" x .35"
140-17881-D	140-17882-D	Drag Kit, Rear LAMB/WILLIAMS, 2.81" Offset, 1/2" Stud Dia.	XRD Drag, Four Piston, Type III Ano	Scalloped, Drilled	11.25" x .35"
140-17883-D	140-17884-D	Drag Kit, Rear LAMB/WILLIAMS, 2.81" Offset, 11/16" Stud Dia.	XRD Drag, Four Piston, Type III Ano	Scalloped, Drilled	11.25" x .35"