



## Big Brake Kits 2024 CAN-AM SxS MAVERICK R

Wilwood brings high-performance brake kits to the UTV market, which is producing faster, more powerful machines than ever before. Approaching five decades of experience, Wilwood has the engineering and manufacturing expertise to produce highly effective brake systems and components for the new generation 6-lug Can-Am, Maverick R.

Front and rear matched kits use radial-mount **Dynapro** four piston calipers and larger dynamically mounted floating rotors that reduce piston knockback, improve thermal capacity, and are game-changers for enthusiasts and competitive racers. **Note:** a modification to the front control arm steering stop is necessary. Refer to the wheel clearance diagram for a fitment check prior to purchase.

### KIT FEATURES:

- A four piston caliper with an FEA (finite element analysis) body design for increased strength and better resistance to deflection
- **Lug-Drive** technology floats the rotor for decreased knockback and removes thermally generated stress, eliminating distortion
- Fully compatible with factory master cylinder, brake lines, and pedals

### CALIPER: NDPR

- **Narrow Dynapro UTV Radial Mount** calipers combine pure race technology in a strong, sleek profile used in a broad range of rally and off-road applications
- Performance kit calipers come in gloss red and black powder coat, with a large variety of other color options available (additional charges may apply)
- Race-spec kit features calipers with a **Type III Hard Anodized** finish

### ROTOR: STEEL, DRILLED or PLAIN FACE

- **Lug-Drive**, dynamically mounted 11.60" x 0.25" steel rotors reduce knockback and thermal distortion
- Performance kit rotors are available in plain face or drilled; Race-spec kits include plain face rotors

### BRAKE PADS:

- Performance front and rear kits ship with **BP-20** compound, while Race-spec front and rear kits include a more aggressive **BP-28** pad (other compounds available)

### INSTALLATION PARTS:

- All premium-grade hardware included

### PERFORMANCE



**CALIPER  
COLOR  
OPTIONS**  
\*Additional charges may apply.

### 6-LUG CAN-AM MAV R



### RACE

#### TYPICAL INSTALLATION CONFIGURATION

##### 2024 Can-Am Mav R Front

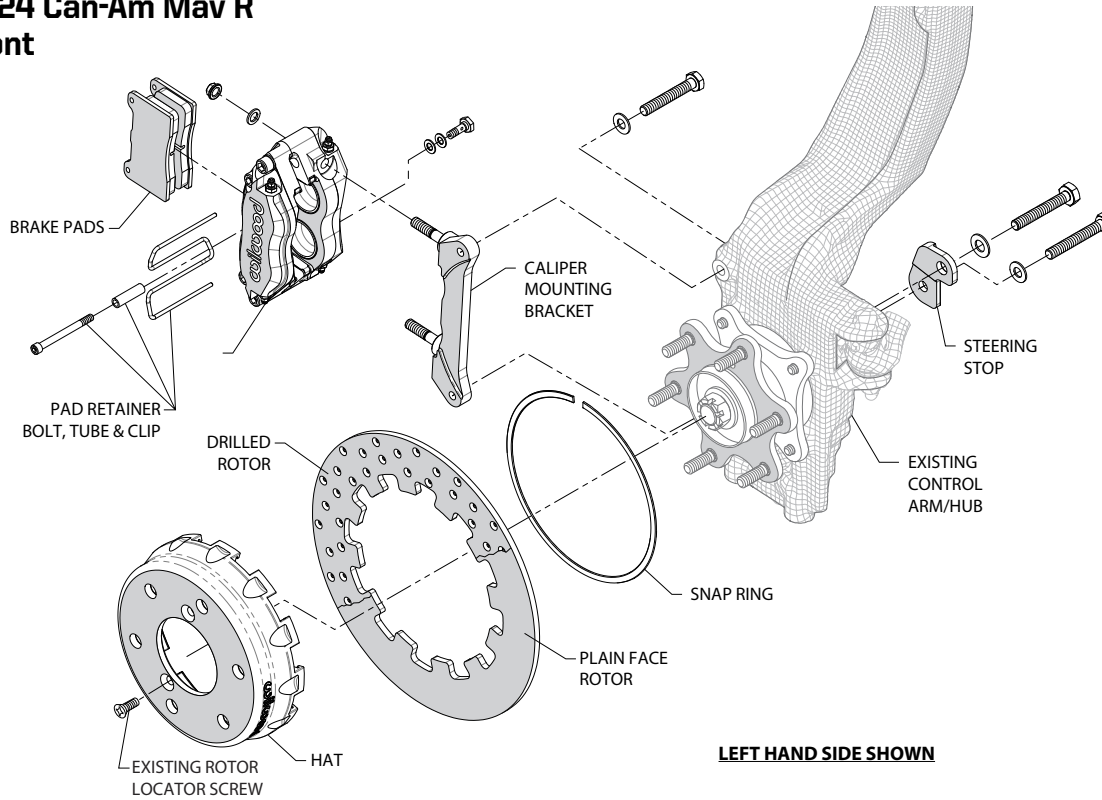

**6-LUG  
CAN-AM  
MAV R**



**NOTE:**  
SPECIFIC PARTS  
MAY VARY FROM  
DIAGRAM

**WARNING**  
INSTALLATION OF THIS KIT SHOULD  
**ONLY** BE PERFORMED BY PERSONS  
EXPERIENCED IN THE INSTALLATION  
AND PROPER OPERATION OF DISC  
BRAKE SYSTEMS.

**LEFT HAND SIDE SHOWN**

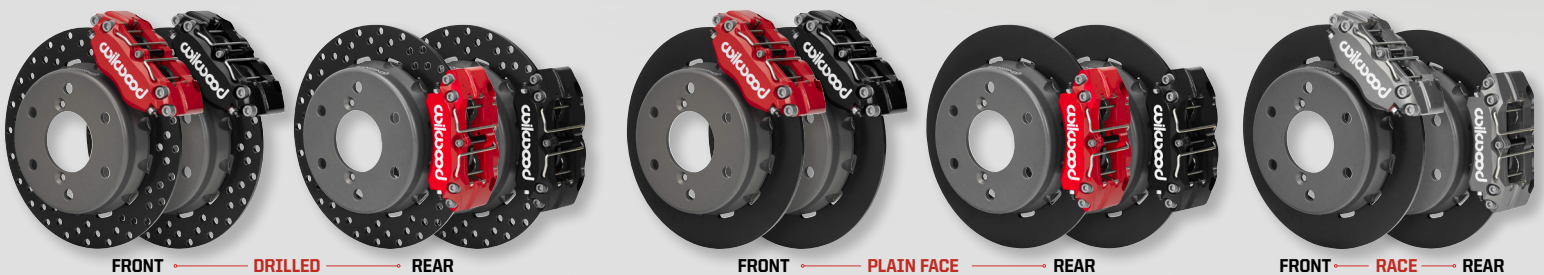

ORDERING INFO: PH: 805.388.1188 • FAX: 805.388.4938 • [wilwood.com](http://wilwood.com) • [info@wilwood.com](mailto:info@wilwood.com)

BLACK	RED	PERFORMANCE KITS	CALIPER TYPE	ROTOR TYPE	ROTOR SIZE
<a href="#">140-17946</a>	<a href="#">140-17946-R</a>	Kit, Front, NDPR, 2024 Can-Am Maverick R, 6-Lug	NDPR, Dynapro 4 Piston	Plain Face Steel	11.60" x 0.25"
<a href="#">140-17946-D</a>	<a href="#">140-17946-DR</a>	Kit, Front, NDPR, 2024 Can-Am Maverick R, 6-Lug	NDPR, Dynapro 4 Piston	Drilled Steel	11.60" x 0.25"
<a href="#">140-17947</a>	<a href="#">140-17947-R</a>	Kit, Rear, NDPR, 2024 Can-Am Maverick R, 6-Lug	NDPR, Dynapro 4 Piston	Plain Face Steel	11.60" x 0.25"
<a href="#">140-17947-D</a>	<a href="#">140-17947-DR</a>	Kit, Rear, NDPR, 2024 Can-Am Maverick R, 6-Lug	NDPR, Dynapro 4 Piston	Drilled Steel	11.60" x 0.25"
TYPE III HARD ANO		RACE-SPEC KITS			
<a href="#">140-18028</a>		Kit, Front, NDPR, 2024 Can-Am Maverick R, 6-Lug, Race Pads	NDPR, Dynapro 4 Piston	Plain Face Steel	11.60" x 0.25"
<a href="#">140-18029</a>		Kit, Rear, NDPR, 2024 Can-Am Maverick R, 6-Lug, Race Pads	NDPR, Dynapro 4 Piston	Plain Face Steel	11.60" x 0.25"